

- Key:**
- 1. Refer to 243442-PUR-01-XX-DR-A-3711 drawing for:
Internal and External elevations and section of Moat Arch door D.A1.01 and totem
 - 2. Refer to 243442-PUR-01-XX-DR-A-3712 drawing for:
Internal and External elevations and section of Moat Arch door D.A2.01 and totem
 - 3. Refer to 243442-PUR-01-XX-DR-A-3713 drawing for:
Internal and External elevations and section of Moat Arch door D.A3.01
 - 4. Refer to 243442-PUR-01-XX-DR-A-3714 drawing for:
Internal and External elevations and section of Moat Arch door D.A4.01
 - 5. Refer to 243442-PUR-01-XX-DR-A-3715 drawing for:
Internal and External elevations and section of Moat Arch door D.A5.01
 - 6. Refer to 243442-PUR-01-XX-DR-A-3716 drawing for:
Internal and External elevations and section of Moat Arch door D.A6.01
 - 7. Refer to 243442-PUR-01-XX-DR-A-3718 drawing for:
Internal and External elevations and section of Moat Arch door D.A7.01
 - 8. Refer to 243442-PUR-01-XX-DR-A-3719 drawing for:
Internal and External elevations and section of Moat Arch door D.A8.01
 - 9. Refer to 243442-PUR-01-XX-DR-A-3720 drawing for:
Internal and External elevations and section of Moat Arch door D.A9.01
 - 10. Refer to 243442-PUR-01-XX-DR-A-3721 drawing for:
Internal and External elevations and section of Moat Arch door D.A10.01
 - 11. Refer to 243442-PUR-01-XX-DR-A-3710 drawing for:
Plans of moat arch doors D.A1.01 – D.A6.01
 - 12. Refer to 243442-PUR-01-XX-DR-A-3717 drawing for:
Plans of moat arch doors D.A7.01 – D.A10.01

Notes:

Drawings are based on survey data and may not accurately represent what is physically present.

Do not scale from this drawing. All dimensions are to be verified on site before proceeding with the work.

All dimensions are in millimetres unless noted otherwise.

Purcell shall be notified in writing of any discrepancies.

All digital information within this DWG format file is the copyright of Purcell Architecture Limited and is for information purposes only. No digital information maybe reused or reproduced by any party for any purpose without written permission.

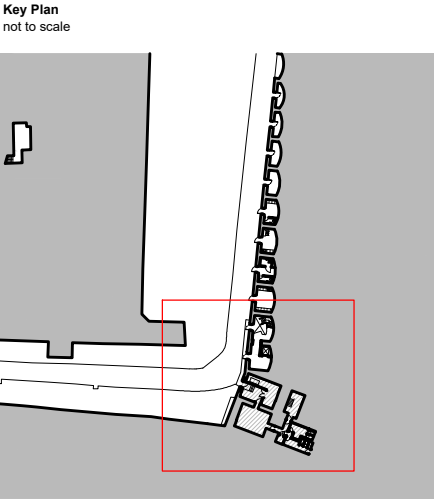

Key

Not in Scope

P05	17.10.2025	RP	KSH	DRAFT TENDER
P04	18.07.2025	KSH	JMcK	STAGE 4 - FOR APPROVAL
P03	27.06.2025	KSH	JMcK	STAGE 4B - FOR INFORMATION
P02	13.06.2025	KSH	JMcK	STAGE 4B - FOR INFORMATION
P01	08.04.2025	KSH	JMcK	FOR INFORMATION
REV	DATE	BY	CHK	DESCRIPTION

CLIENT
Historic Royal Palaces

PROJECT
Tower of London Education Facilities

JOB NUMBER
243442

TITLE
Conservation Repairs and Works -
Proposed Moat Level Call-out Plan (1 of 2)

SIZE	SCALE
A3L	1:200
REV	SUITABILITY/REASON FOR ISSUE
P05	S4 - FOR APPROVAL
DRAWING NUMBER	
243442-PUR-01-B1-DR-A-2006	
PURCELL® IS THE REGISTERED TRADE NAME FOR PURCELL ARCHITECTURE LTD AND ALL SUBSIDIARY COMPANIES AND IS REGISTERED IN THE UNITED KINGDOM, EUROPEAN UNION, HONG KONG, CHINA AND AUSTRALIA. © PURCELL 2025. www.purcella.com	

1 Proposed Moat level floor plan
2006 1:200

